

AURELIUS TOWNSHIP, T.2N. - R.2W. , INGHAM COUNTY, MICHIGAN

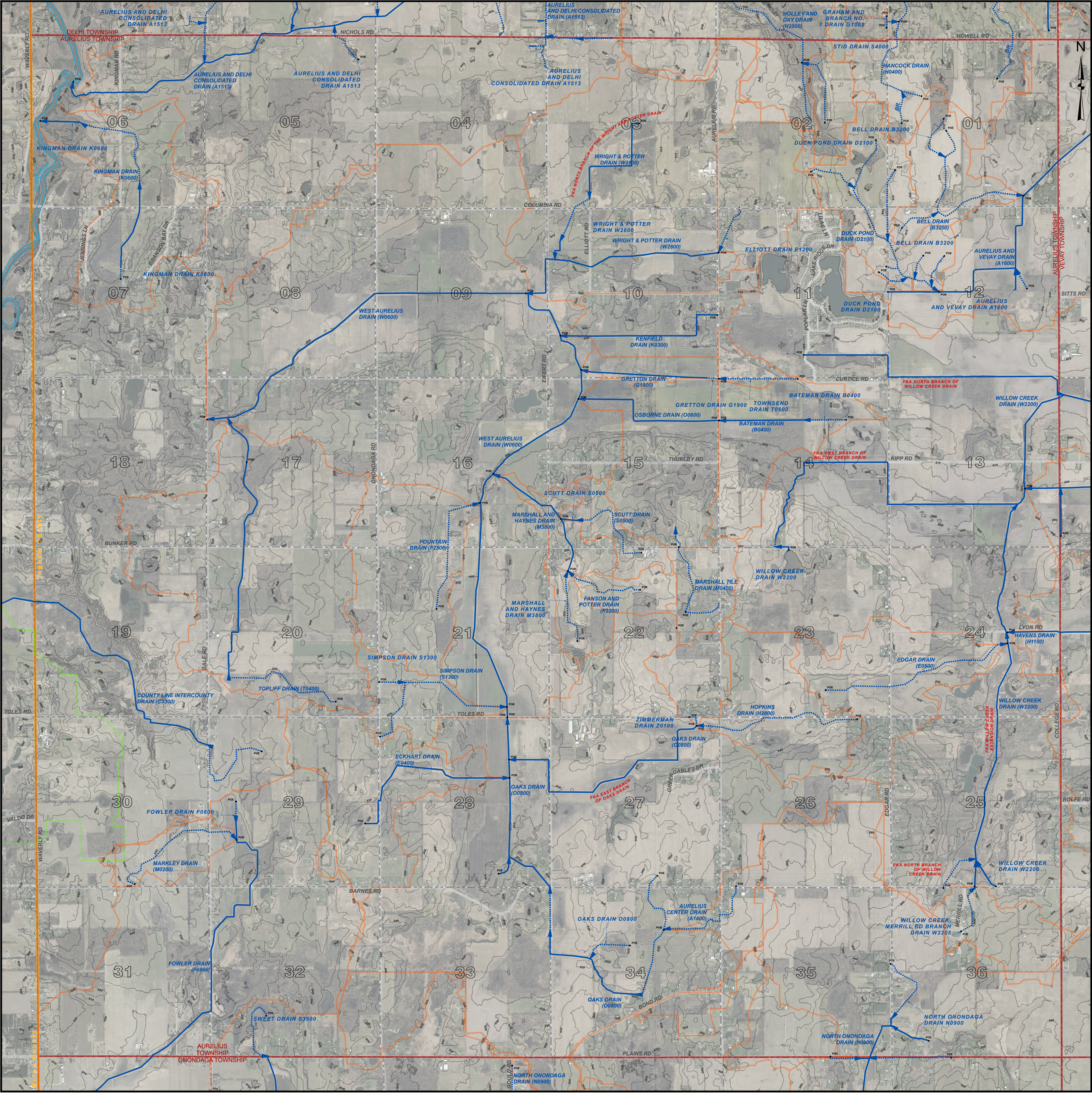

PATRICK E. LINDEMANN
INGHAM COUNTY DRAIN COMMISSIONER

PRELIMINARY

AURELIUS TOWNSHIP DRAIN MAP
T.2N. - R.2W.
INGHAM COUNTY, MICHIGAN

707 BURL AVENUE
P.O. BOX 220
MASON, MI 48854
PHONE: (517)-676-8395
FAX: (517)-676-8364

LEGEND

- MUNICIPAL BOUNDARIES
- SECTIONS
- COUNTY
- DRAINAGE DISTRICT BOUNDARIES
- OTHER INTERCOUNTY DISTRICT BOUNDARIES
- OPEN DRAIN
- CLOSED DRAIN
- ROADS
- RAILROADS
- NATURAL WATERCOURSE
- RED = FORMERLY KNOWN AS

DISCLAIMER:

This map is a generalized representation of established drain routes and courses and/or drainage district boundaries. It is provided by the Ingham County Drain Commissioner for reference and display purposes only and does not confirm, create, refute, remove, expand, alter or otherwise affect any rights or obligations recognized or imposed by federal, state or local law, ordinance, regulation or rule.

1 INCH = 1,000 FEET

DRAIN INDEX

Drain No.	Drain Name	Drain No.	Drain Name	Drain No.	Drain Name
A1400	AURELIUS CENTER DRAIN	F2500	FOUNTAIN DRAIN	O0800	OAKS DRAIN
A1513	AURELIUS AND DELHI CONSOLIDATED DRAIN	G1900	GRETTON DRAIN	P0800	PLAINS ROAD DRAIN
A1600	AURELIUS AND VEYAY DRAIN	H0400	HANCOCK DRAIN	S0500	SCUTT DRAIN
B0400	BATEMAN DRAIN	H1100	HAVENS DRAIN	S1300	SIMPSON DRAIN
B3200	BELL DRAIN	H2500	HOLLEY AND DAY DRAIN	S3500	SWEET DRAIN
C2200	COLLINS DRAIN	H2800	HOPKINS DRAIN	S4000	STID DRAIN
C3300	COUNTY LINE INTERCOUNTY DRAIN	K0300	KENFIELD DRAIN	T0400	TOPLIFF DRAIN
D2100	DUCK POND DRAIN	K0600	KINGMAN DRAIN	T0600	TOWNSEND DRAIN
E0400	ECKHART DRAIN	M0200	MARKLEY DRAIN	W0600	WEST AURELIUS DRAIN
E0500	EDGAR DRAIN	M0400	MARSHALL TILE DRAIN	W2200	WILLOW CREEK DRAIN
E1200	ELLIOTT DRAIN	M3800	MARSHALL AND HAYNES DRAIN	W2205	WILLOW CREEK, MERRILL RD BRANCH DRAIN
F0800	FOWLER DRAIN	N0900	NORTH ONONDAGA DRAIN	W2800	WRIGHT & POTTER DRAIN
F2200	FANSON AND POTTER DRAIN	O0600	OSBORNE DRAIN	Z0100	ZIMMERMAN DRAIN